

GM2E 315 S 4

IE2

GAMAK

3-Phase 400 V (Δ) 50 Hz

Duty Type : S1

Degree of protection : IP 55 (TEFC)

Insulation class : F (155 °C)

Temp rise : Class B (80K)

Mounting Design : B3

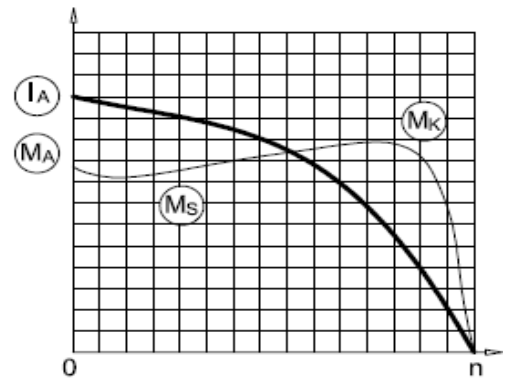

ELECTRICAL DESIGN

Direct On Line

Rated output (kW) : 110

Locked rotor Current – I_a (A) : 1365

I_a / I_n : 7.0

Speed (rpm) : 1485

Locked rotor Torque – M_a (Nm) : 1626

M_a / M_n : 2.3

Rated current (A) : 195

Y / Δ Starting

Torque – M_n (Nm) : 707

Locked rotor Current – I_a (A) : 449

I_a / I_n : 2.3

Cos φ : 0.86

Locked rotor Torque – M_a (Nm) : 495

M_a / M_n : 0.7

Efficiency % :

4/4	3/4	1/2
94.5	94.5	93.8

Moment of inertia J (kgm)² : 2.1

Breakdown Torque – M_k (Nm) : 1838

M_k / M_n : 2.6

MECHANICAL DESIGN

Frame : Cast Iron

End shields : Cast Iron

Cooling fan : Plastic

Terminal box : Aluminium

Cable gland : Pg 48

No of cable glands : 2

Bearing Arrangement

Standard design

Drive End

6318 C3

Non Drive End

6318 C3

Reinforced design

NU 318 E

6318 C3

Noise Level (dB-A) : 74

Paint : RAL 7031- Grey

Approximate weight (kg) : 784

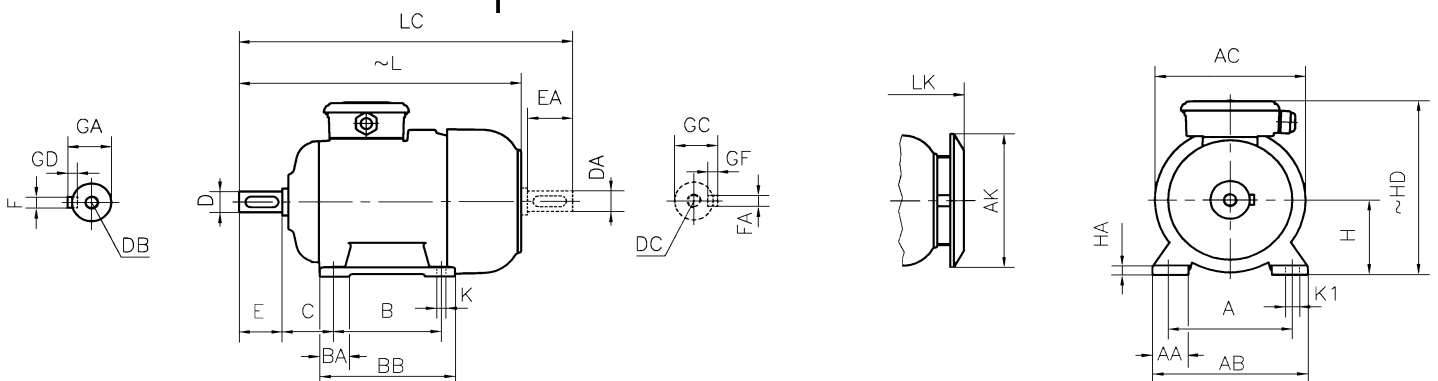

DIMENSIONS

Dimensions of foot mounted motors for mounting arrangement : B3, B6, B7, B8, B15, V5, V6

H	HD	HA	A	AA	AB	ØAC	ØAK	K	K1	B	B'	BA	BA'	BB	L	LC	LK	C	E	DB	ØD	GA	FxGD
~	~													~		~		EA	DC	ØDA	GC	FAXGF	
315	825	50	508	125	620	614	51	28	-	406	-	115	166	550	1150	1330	1227	216	170	M20	85	90	22X14

* Efficiencies are calculated according to indirect method where the additional load losses are determined from exact measurements at different load points.