

GM2E 250 M 4

IE2

GAMAK

3-Phase 400 V (Δ) 50 Hz

Duty Type : S1

Degree of protection : IP 55 (TEFC)

Insulation class : F (155 °C)

Temp rise : Class B (80K)

Mounting Design : B3

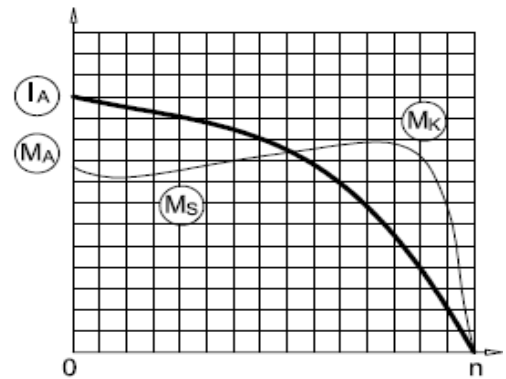

ELECTRICAL DESIGN

Direct On Line

Rated output (kW) : 55

Locked rotor Current – Ia (A) : 730

Ia / In : 7.6

Speed (rpm) : 1475

Locked rotor Torque – Ma (Nm) : 1104

Ma / Mn : 3.1

Rated current (A) : 96

Y / Δ Starting

Torque – Mn (Nm) : 356

Locked rotor Current – Ia (A) : 240

Ia / In : 2.5

Cos φ : 0.88

Locked rotor Torque – Ma (Nm) : 356

	4/4	3/4	1/2
Efficiency %	93.7	93.8	93.2

Ma / Mn : 1.0

Moment of inertia J (kgm)² : 0.72

Breakdown Torque – Mk (Nm) : 1032

Mk / Mn : 2.9

MECHANICAL DESIGN

Frame : Cast Iron

End shields : Cast Iron

Cooling fan : Plastic

Terminal box : Aluminium

Cable gland : Pg 42

No of cable glands : 2

Bearing Arrangement

Standard design

Drive End

6315 ZZ C3

Non Drive End

6215 ZZ C3

Reinforced design

NU 315 E

6315 C3

Noise Level (dB-A) : 67

Paint : RAL 7031- Grey

Approximate weight (kg) : 420

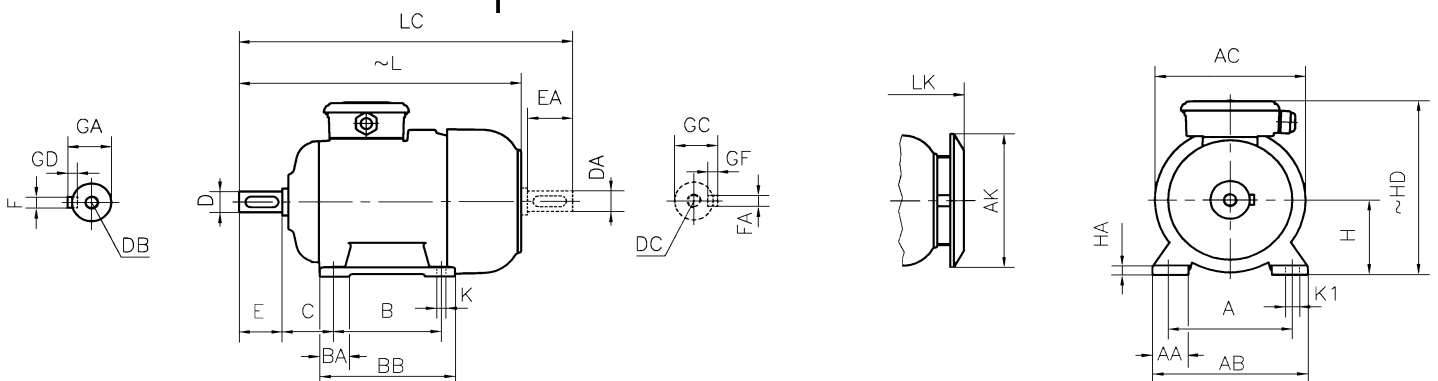

DIMENSIONS

Dimensions of foot mounted motors for mounting arrangement : B3, B6, B7, B8, B15, V5, V6																							
H	HD ~	HA	A	AA	AB	ØAC	ØAK	K	K1	B	B'	BA	BA'	BB	L ~	LC	LK ~	C	E EA	DB DC	ØD ØDA	GA GC	FxGD FAXGF
250	572	35	406	80	484	480	440	24	-	349	-	75	-	410	896	1044	952	168	140	M20	65	69	18X11

* Efficiencies are calculated according to indirect method where the additional load losses are determined from exact measurements at different load points.