

GM2E 225 M 4

IE2

GAMAK

3-Phase 400 V (Δ) 50 Hz

Duty Type : S1

Degree of protection : IP 55 (TEFC)

Insulation class : F (155 °C)

Temp rise : Class B (80K)

Mounting Design : B3

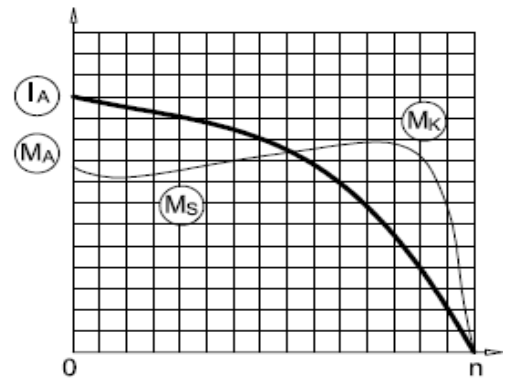

ELECTRICAL DESIGN

Direct On Line

Rated output (kW) : 45

Locked rotor Current – Ia (A) : 584

Ia / In : 7.3

Speed (rpm) : 1470

Locked rotor Torque – Ma (Nm) : 876

Ma / Mn : 3.0

Rated current (A) : 80

Y / Δ Starting

Torque – Mn (Nm) : 292

Locked rotor Current – Ia (A) : 192

Ia / In : 2.4

Cos φ : 0.87

Locked rotor Torque – Ma (Nm) : 292

Ma / Mn : 1.0

	4/4	3/4	1/2
Efficiency %	93.3	93.3	92.4

Moment of inertia J (kgm)² : 0.36

Breakdown Torque – Mk (Nm) : 876

Mk / Mn : 3.0

MECHANICAL DESIGN

Frame : Cast Iron

End shields : Cast Iron

Cooling fan : Plastic

Terminal box : Aluminium

Cable gland : Pg 36

No of cable glands : 2

Bearing Arrangement

Standard design

Drive End

6313 ZZ C3

Non Drive End

6213 ZZ C3

Reinforced design

NU 313 E

6313 C3

Noise Level (dB-A) : 64

Paint : RAL 7031- Grey

Approximate weight (kg) : 330

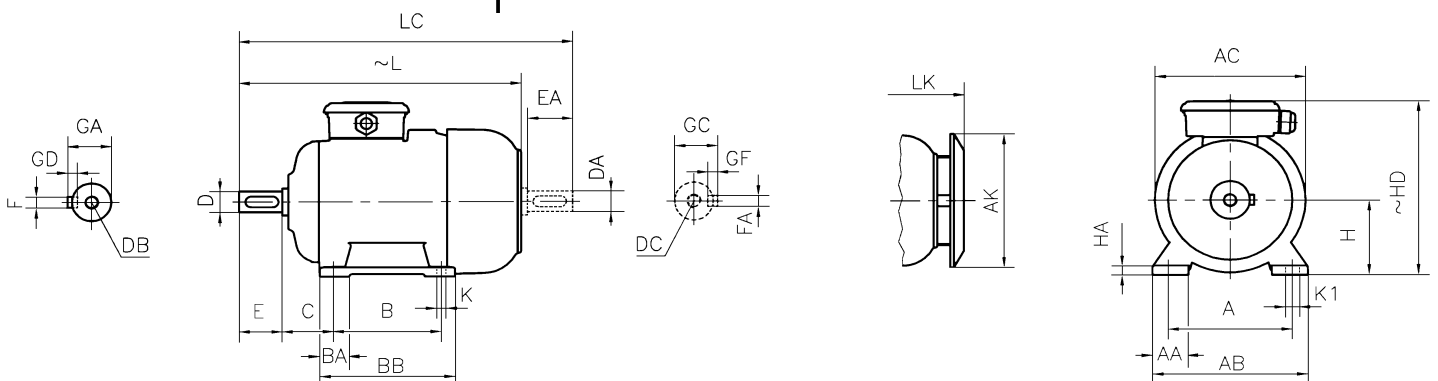

DIMENSIONS

Dimensions of foot mounted motors for mounting arrangement : B3, B6, B7, B8, B15, V5, V6

H	HD ~	HA	A	AA	AB	ØAC	ØAK	K	K1	B	B'	BA	BA'	BB	L ~	LC	LK ~	C	E EA	DB DC	ØD ØDA	GA GC	FxGD FAXGF
225	510	30	356	82	438	434	370	19	-	311	-	76	-	371	820	968	876	149	140	M20	60	64	18X11

* Efficiencies are calculated according to indirect method where the additional load losses are determined from exact measurements at different load points.