

AGM2E 180 L 4

IE2

GAMAK

3-Phase 400 V (Δ) 50 Hz

Duty Type : S1

Degree of protection : IP 55 (TEFC)

Insulation class : F (155 °C)

Temp rise : Class B (80K)

Mounting Design : B3

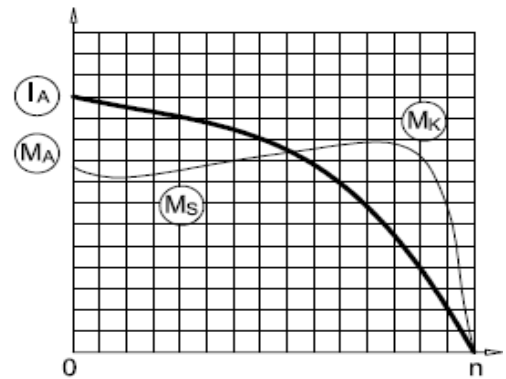

ELECTRICAL DESIGN

Direct On Line

Rated output (kW) : 22

Locked rotor Current – Ia (A) : 353

Ia / In : 8.3

Speed (rpm) : 1470

Locked rotor Torque – Ma (Nm) : 386

Ma / Mn : 2.7

Rated current (A) : 42.5

Y / Δ Starting

Torque – Mn (Nm) : 143

Locked rotor Current – Ia (A) : 115

Ia / In : 2.7

Cos φ : 0.82

Locked rotor Torque – Ma (Nm) : 172

Efficiency % : $\frac{4/4}{91.7}$ $\frac{3/4}{91.4}$ $\frac{1/2}{90.6}$

Ma / Mn : 1.2

Moment of inertia J (kgm)² : 0.15

Breakdown Torque – Mk (Nm) : 543

Mk / Mn : 3.8

MECHANICAL DESIGN

Frame : Aluminium

End shields : Aluminium

Cooling fan : Plastic

Terminal box : Plastic

Cable gland : Pg 29

No of cable glands : 2

Bearing Arrangement

Standard design

Drive End

6310 ZZ C3

Non Drive End

6210 ZZ C3

Reinforced design

NU 310 E

6310 C3

Noise Level (dB-A) : 64

Paint : RAL 7031- Grey

Approximate weight (kg) : 160

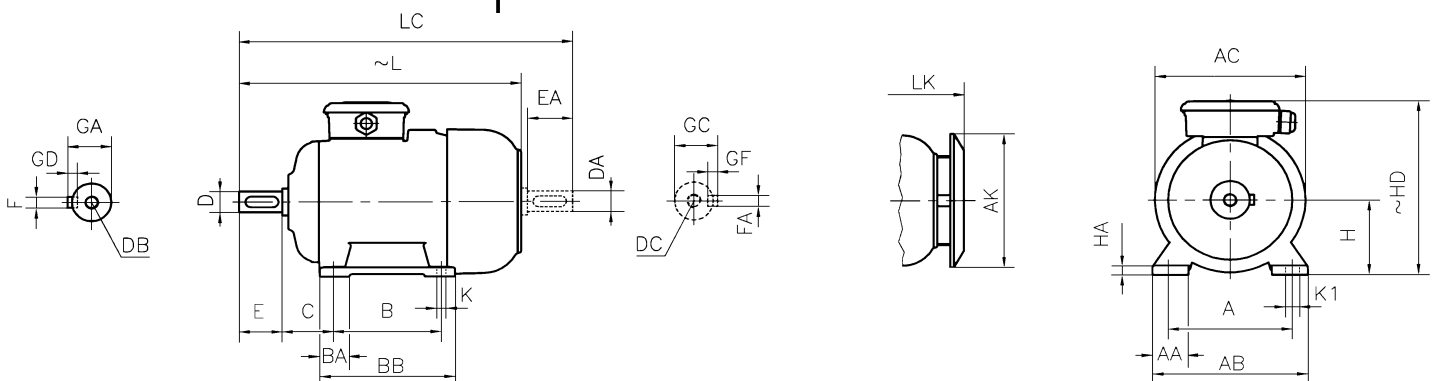

DIMENSIONS

Dimensions of foot mounted motors for mounting arrangement : B3, B6, B7, B8, B15, V5, V6

H	HD ~	HA	A	AA	AB	ØAC	ØAK	K	K1	B	B'	BA	BA'	BB	L ~	LC	LK ~	C	E EA	DB DC	ØD ØDA	GA GC	FxGD FAXGF
180	421	24	279	68	354	348	303	15	19	241	279	57	95	320	657	773	714	121	110	M16	48	51.5	14X9

* Efficiencies are calculated according to indirect method where the additional load losses are determined from exact measurements at different load points.