

AGM2E 200 L 2b

IE2

GAMAK

3-Phase 400 V (Δ) 50 Hz

Duty Type : S1

Degree of protection : IP 55 (TEFC)

Insulation class : F (155 °C)

Temp rise : Class B (80K)

Mounting Design : B3

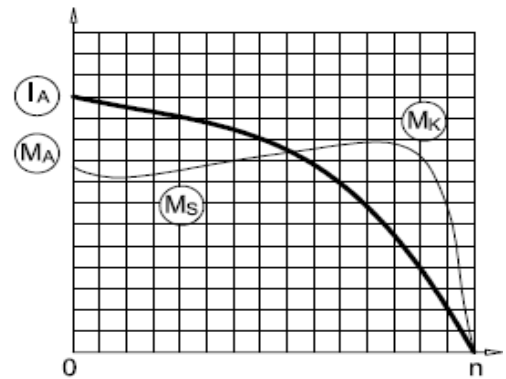

ELECTRICAL DESIGN

Direct On Line

Rated output (kW) : 37

Locked rotor Current – Ia (A) : 540

Ia / In : 8.3

Speed (rpm) : 2970

Locked rotor Torque – Ma (Nm) : 321

Ma / Mn : 2.7

Rated current (A) : 65

Y / Δ Starting

Torque – Mn (Nm) : 119

Locked rotor Current – Ia (A) : 176

Ia / In : 2.7

Cos φ : 0.89

Locked rotor Torque – Ma (Nm) : 107

Efficiency %	4/4	3/4	1/2
	92.6	92.6	91.7

Ma / Mn : 0.9

Moment of inertia J (kgm)² : 0.15

Breakdown Torque – Mk (Nm) : 357

Mk / Mn : 3.0

MECHANICAL DESIGN

Frame : Aluminium

End shields : Cast Iron

Cooling fan : Plastic

Terminal box : Aluminium

Cable gland : Pg 36

No of cable glands : 2

Bearing Arrangement

Standard design

Drive End

6312 ZZ C3

Non Drive End

6212 ZZ C3

Reinforced design

NU 312 E

6312 C3

Noise Level (dB-A) : 73

Paint : RAL 7031- Grey

Approximate weight (kg) : 190

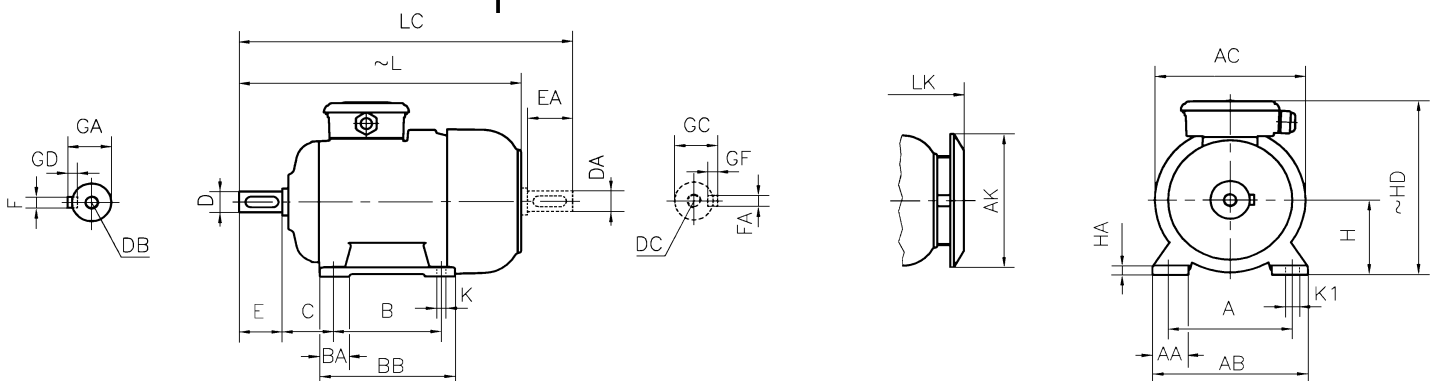

DIMENSIONS

Dimensions of foot mounted motors for mounting arrangement : B3, B6, B7, B8, B15, V5, V6

H	HD ~	HA	A	AA	AB	ØAC	ØAK	K	K1	B	B'	BA	BA'	BB	L ~	LC	LK ~	C	E EA	DB DC	ØD ØDA	GA GC	FxGD FAXGF
200	477	26	318	80	398	390	370	19	24	305	-	68	-	355	747	865	803	133	110	M20	55	59	16X10

* Efficiencies are calculated according to indirect method where the additional load losses are determined from exact measurements at different load points.