

-PEK-

**DUVAR TİPİ AKSİYEL BACA
ASPİRATÖRLERİ (RULMANLI)**

MODEL	GERİLİM (VOLT/HZ)	GÜÇ (WATT)	AKIM (A)	DEVİR (d/d)	DEBİ (m ³ /h)	SES (DBA)
PEK 200	230/50	40	0,37	1400	340	37
PEK 250	230/50	40	0,42	1400	670	42
PEK 300	230/50	50	0,48	1400	1145	48
PEK 350	230/50	65	0,50	1400	1900	54

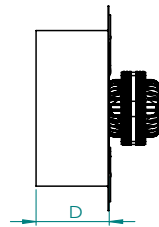
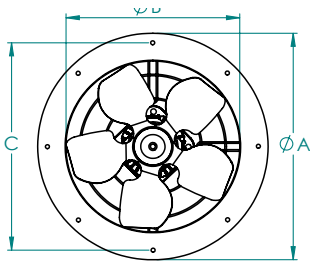
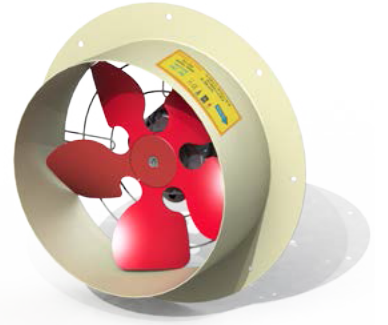

MODEL	A	B	C	D
PEK-200	270	210	250	50
PEK-250	320	260	300	50
PEK-300	380	310	360	45
PEK-350	430	360	410	45